

# FrontGuard 46 and FrontGuard 65 Entrance Doors

## FrontGuard Steel (FGS) Door

### Door design

Steel door leaf with foam filled core and thermal break overlapping the leaf, aluminium frame and multi-point locking. Supplied in polyester primer coating in Traffic White (RAL 9016) in a smooth finish (inside and out). Exterior and interior in the same colour.

### Insulation

FrontGuard 46 doors have a 46mm thick door panel and FrontGuard 65 doors have a 65mm thick door panel.

### Surface

Flush fitting door leaf on the interior and exterior of the door, with a leaf frame on the inside and a thick rebate. The flush fit on the interior gives the impression of a residential internal door can be optimally integrated into your house's interior.

### Colours

White (RAL 9016) as standard.

Optional colours available for all doors:

- |                           |                                  |                          |                              |
|---------------------------|----------------------------------|--------------------------|------------------------------|
| - Light Ivory (RAL 1015)  | - Moss Green (RAL 6005)          | - Dusty Grey (RAL 7037)  | - Grey White (RAL 9002)      |
| - Flame Red (RAL 3000)    | - Basalt Grey (RAL 7012)         | - Quartz Grey (RAL 7039) | - White Aluminium (RAL 9006) |
| - Ruby Red (RAL 3003)     | - Slate Grey (RAL 7015)          | - Window Grey (RAL 7040) | - Grey Aluminium (CH 907)    |
| - Purple Red (RAL 3004)   | - Anthracite Grey (RAL 7016)     | - Clay Brown (RAL 8003)  |                              |
| - Gentian Blue (RAL 5010) | - Titan Metallic finish (CH 703) | - Terra Brown (RAL 8028) |                              |
| - Pigeon Blue (RAL 5014)  | - Light Grey (RAL 7035)          | - Cream (RAL 9001)       |                              |

### Timber Effect (available for FGS 010, FGS 015, FGS 700 and FGS 900)

- |                           |            |             |                  |
|---------------------------|------------|-------------|------------------|
| - Golden Oak              | - Dark Oak | - Night Oak | - Winchester Oak |
| - Titan Metallic (CH 703) |            |             |                  |

### Matt Deluxe Colours

- |                                |                             |                            |                           |
|--------------------------------|-----------------------------|----------------------------|---------------------------|
| - Anthracite Grey (CH 7016)    | - Terra Brown (CH 8028)     | - Grey Aluminium (CH 9007) | - Traffic White (CH 9016) |
| - Anthracite Metallic (CH 703) | - White Aluminium (CH 9006) |                            |                           |

### Seals

4-sided double, black EPDM seals. Brush seal at the bottom, 20 mm high plastic threshold with thermal break.

### Locks & bolts

11-point security: 2 conical swing bolts engage with 2 additional security bolts and 1 deadbolt in the frame's lock plates. 3 further security bolts on the hinge side and three barrel hinges.

### Drip angle

Optional, Traffic White (RAL 9016). Invisible fastening and plastic cover cap at each end.

### Hinges

Three 2-piece 3-way adjustable hinges with hinge caps in aluminium look.

### Handles / Letter plates

Lever/lever handle set and letter plate in silver to choose as standard on classic designs.

Contemporary and modern designs all have fixed bar handles on the outside and therefore a key is required to open these doors from the outside at all times.

### Profile cylinder and keys

Cylinder length with fixed bar handles: 27.5 x 35.5 mm.

Cylinder length with standard lever/lever or lever/knob handle set: 31.5 x 40.5 mm.

5 keys supplied as standard, 8 or 10 keys available as an option.

### Packaging

FrontGuard doors are packed with polystyrene around the door and then shrink wrapped. Side elements are transported with glass already fitted.

### Stock availability

Made to order. Approximately 8 weeks lead-time.

### FrontGuard 46 Designs

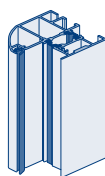
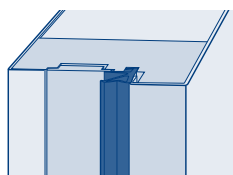

Profile A1

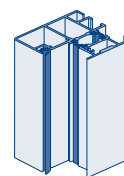

Profile A2

Size (W x H)	RAL 9016	Colour	Matt Deluxe	Timber Effect & CH 703
--------------	----------	--------	-------------	------------------------

### Modern

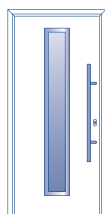

#### FGS 700

- 3 panes of insulated glass, exterior laminated safety glass, sand-blasted float with 7 clear strips. Interior has single-pane safety glass.
- Stainless steel glazing frame.

1000 x 2100 1100 x 2100	1745	1870	1967	1995
from 700 x 1875 up to 1250 x 2250	2132	2256	2353	2381
U <sub>D</sub> -value for size 1230 x 2180 mm: approx. 1.2 W/(m <sup>2</sup> ·K)				

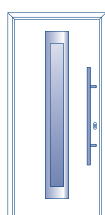

#### FGS 750

- 3 panes of insulated glass, exterior laminated safety glass, sand-blasted float with 5 clear strips. Interior has laminated safety glass.
- Stainless steel glazing frame.

1000 x 2100 1100 x 2100	1745	1870	1967	1995
from 875 x 1990 up to 1250 x 2250	2132	2256	2353	2381
U <sub>D</sub> -value for size 1230 x 2180 mm: approx. 1.2 W/(m <sup>2</sup> ·K)				

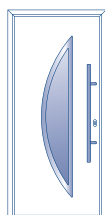

#### FGS 900

- 3 panes of insulated glass, exterior laminated safety glass, sand-blasted float with 4 clear strips. Interior has single-pane safety glass.
- Stainless steel glazing frame.

1000 x 2100 1100 x 2100	1797	1922	2018	2046
from 800 x 1875 up to 1250 x 2250	2183	2308	2405	2432
U <sub>D</sub> -value for size 1230 x 2180 mm: approx. 1.2 W/(m <sup>2</sup> ·K)				

### Classic



#### FGS 100

1000 x 2100 1100 x 2100	1308	1432	1529	-
from 875 x 1875 up to 1100 x 2186	1693	1818	1914	-
U <sub>D</sub> -value for size 1230 x 2180 mm: approx. 1.1 W/(m <sup>2</sup> ·K)				



#### FGS 200

- 2 panes of insulated glass: Exterior has single-pane safety glass. Interior has single pane safety Cathedral glass with small hammered finish.
- Plastic glazing frame with surface mounted rails.

1000 x 2100 1100 x 2100	1603	2015	2112	-
from 875 x 1990 up to 1100 x 2186	1988	2400	2497	-
U <sub>D</sub> -value for size 1230 x 2180 mm: approx. 1.2 W/(m <sup>2</sup> ·K)				



#### FGS 400

- 2 panes of insulated glass: Exterior has laminated safety glass. Interior has single pane safety Cathedral glass with small hammered finish.
- Plastic glazing frame with surface mounted rails.

1000 x 2100 1100 x 2100	1467	1879	1976	-
from 875 x 1875 up to 1100 x 2186	1853	2265	2361	-
U <sub>D</sub> -value for size 1230 x 2180 mm: approx. 1.4 W/(m <sup>2</sup> ·K)				

FrontGuard 46 Designs

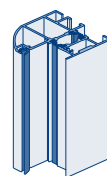
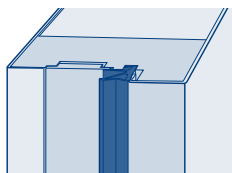

Profile A1

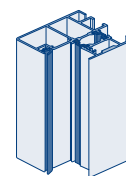

Profile A2

Size (W x H)	RAL 9016	Colour	Matt Deluxe	Timber Effect & CH 703
--------------	----------	--------	-------------	------------------------

Contemporary



FGS 010

1000 x 2100 1100 x 2100	1260	1385	1482	1510
from 700 x 1875 up to 1250 x 2250	1645	1770	1867	1895
U <sub>D</sub> -value for size 1230 x 2180 mm: approx. 1.1 W/(m <sup>2</sup> ·K)				



FGS 015

1000 x 2100 1100 x 2100	1308	1432	1529	1557
from 875 x 1875 up to 1250 x 2250	1693	1818	1914	1942
U <sub>D</sub> -value for size 1230 x 2180 mm: approx. 1.1 W/(m <sup>2</sup> ·K)				



FGS 515

1000 x 2100 1100 x 2100	1308	1432	1529	1557
from 700 x 1875 up to 1250 x 2250	1693	1818	1914	1942
U <sub>D</sub> -value for size 1230 x 2180 mm: approx. 1.1 W/(m <sup>2</sup> ·K)				



FGS 020

- 2 panes of insulated glass, exterior laminated safety glass and interior single-pane safety glass satinato.
- Plastic glazing frame in door leaf colour (excludes timber effects).

1000 x 2100 1100 x 2100	1520	1932	2029	2057
from 700 x 1875 up to 1250 x 2250	1906	2318	2415	2444
U <sub>D</sub> -value for size 1230 x 2180 mm: approx. 1.4 W/(m <sup>2</sup> ·K)				



FGS 025

- 2 panes of insulated glass, exterior laminated safety glass and interior single-pane safety glass satinato.
- Plastic glazing frame in door leaf colour (excludes timber effects).

1000 x 2100 1100 x 2100	1603	2015	2112	2141
from 875 x 1875 up to 1250 x 2250	1988	2400	2497	2526
U <sub>D</sub> -value for size 1230 x 2180 mm: approx. 1.4 W/(m <sup>2</sup> ·K)				



FGS 030

- 2 panes of insulated glass, exterior laminated safety glass and interior single-pane safety glass satinato.
- Plastic glazing frame in door leaf colour (excludes timber effects).

1000 x 2100 1100 x 2100	1745	2157	2254	2283
from 700 x 1875 up to 1250 x 2250	2132	2544	2640	2669
U <sub>D</sub> -value for size 1230 x 2180 mm: approx. 1.3 W/(m <sup>2</sup> ·K)				



FGS 040

- 2 panes of insulated glass, exterior laminated safety glass and interior single-pane safety glass satinato.
- Plastic glazing frame in door leaf colour (excludes timber effects).

1000 x 2100 1100 x 2100	1520	1932	2029	2057
from 700 x 1875 up to 1250 x 2250	1906	2318	2415	2444
U <sub>D</sub> -value for size 1230 x 2180 mm: approx. 1.2 W/(m <sup>2</sup> ·K)				

## FrontGuard 46 Designs – Side elements and transom lights

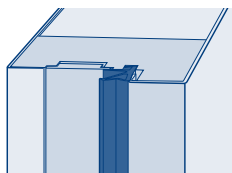

Ordering sizes Overall frame (W x H)	Glass	RAL 9016	Colour	Matt Deluxe	Timber Effect & CH 703
---	-------	----------	--------	-------------	------------------------

### Side Element

#### Fixed side element assembly

- Not possible for door assemblies opening outwards!
- Not possible in conjunction with RC 2!

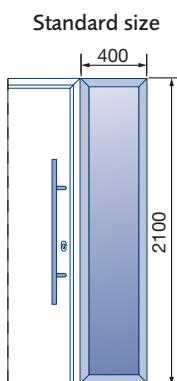

Standard size 400 x 2100	Clear	817	949	1038	992
	Satinato	817	949	1038	992
	Cathedral glass	817	949	1038	992
	Sand-blasted	817	949	1038	992
	Sand-blasted with clear stripes	1378	1509	1038	1553

### Side Element

#### Fixed side element assembly

- Not possible for door assemblies opening outwards!
- Not possible in conjunction with RC 2!

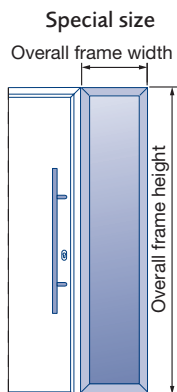

Special size Overall frame width Overall frame height	From 300 x 700 Up to 500 x 2250	Clear, Satinato, cathedral glass or sand-blasted	1017	1150	1238	1192
	Up to 1000 x 2250 <sup>1</sup>		1214	1347	1435	1390
	From 300 x 1875 Up to 500 x 2250	Sand-blasted with clear stripes	1725	1857	1945	1900
	Up to 1000 x 2250 <sup>1</sup>		1920	2052	2141	2096

<sup>1</sup> Only possible without transom light  
Door set with side element does not contribute to the static equilibrium.  
Statics must be ensured by the building structure.

### Transom light

#### Fixed transom light assembly

- Not possible for door assemblies opening outwards!
- Not possible in conjunction with RC 2!

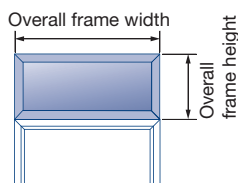





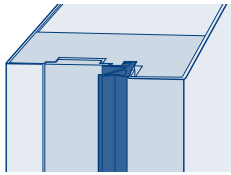







Overall frame width Overall frame height	From 700 x 300 Up to 1250 x 500	Clear, Satinato, cathedral glass or sand-blasted	768	901	989	944
	Up to 2250 x 500		1017	1150	1238	1192

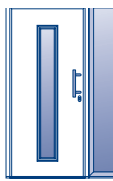

FrontGuard 46 Designs – Overview of panels / glass for side elements



Infill / size range  
Glass design: Exterior pane clear laminated safety glass – interior pane

	Style	Glass(interior pane)	Size range	
			Side element	Transom light
Modern	 FGS 700  FGS 750	1. Clear laminated safety glass / sand-blasted laminated safety glass (without clear stripes) 2. Clear laminated safety glass / clear laminated safety glass	Width 300 - 1000 mm  Height 1990 - 2250 mm	Width 875 - 2250 mm  Height 300 - 500 mm
	 FGS 900			
Contemporary	 FGS 010  FGS 015  FGS 515	1. Clear laminated safety glass / Mastercarré single-pane safety glass 2. Clear laminated safety glass / single-pane safety ornamental glass 504 3. Clear laminated safety glass / sand-blasted laminated safety glass (without clear stripes) 4. Clear laminated safety glass / clear laminated safety glass	Width 300 - 1000 mm  Height 1875 - 2250 mm	Width 700 - 2250 mm  Height 300 - 500 mm
	 FGS 020  FGS 025  FGS 030			
	 FGS 040			
Classic	 FGS 100  FGS 200	1. Element with 3 panels 2. Clear laminated safety glass / clear laminated safety glass 3. Clear laminated safety glass / single-pane safety cathedral glass	Width panel 450 mm, width glass 300 - 1000 mm  Height 1875 - 2186 mm	Width 875 - 2250 mm  Height 300 - 500 mm
	 FGS 400			
		1. Element with 1 panel and glazing cut-out with clear laminated safety glass / single-pane safety cathedral glass 2. Clear laminated safety glass / clear laminated safety glass 3. Clear laminated safety glass / single-pane safety cathedral glass	Width panel 450 mm, width glass 300 - 1000 mm  Height 1875 - 2186 mm	Width 875 - 2250 mm  Height 300 - 500 mm

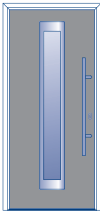
### FrontGuard 46 Designs – Door leaf and frame in different colours/surfaces

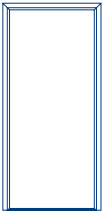
Colours of Leaf and frame differ			Door leaf	Frame	Price for entrance door with surface
 <p>Example</p>  <p>Door leaf Anthracite grey</p>  <p>Frame Traffic white</p>	RAL 9016	Color	Color		
	RAL 9016	Timber effect / CH 703	Timber effect / CH 703		
	Color	RAL 9016	Timber effect / CH 703		
	Color	Timber effect / CH 703	Timber effect / CH 703		
	Timber effect / CH 703	RAL 9016	Timber effect / CH 703		
	Timber effect / CH 703	Timber effect / CH 703	Timber effect / CH 703		

### FrontGuard 46 Designs – Bottom Spacer Profile

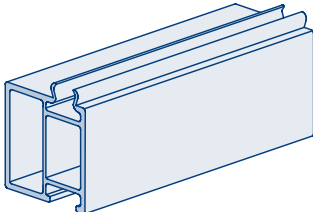
 <p>Bottom spacer profile</p>	Length up to 1250 mm	Height	30 mm	Each	28
		Height	60 mm	Each	55
		Height	90 mm	Each	83
		Height	120 mm	Each	110
		Height	150 mm	Each	136
	Length up to 2250 mm	Height	30 mm	Each	46
		Height	60 mm	Each	91
		Height	90 mm	Each	136
		Height	120 mm	Each	182
		Height	150 mm	Each	227
	Length up to 3250 mm	Height	30 mm	Each	65
		Height	60 mm	Each	130
		Height	90 mm	Each	194
		Height	120 mm	Each	259
		Height	150 mm	Each	324

### FrontGuard 46 Designs – Extension profile

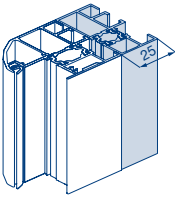
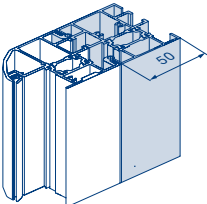
Extension profile 25 mm Dimensions (W x D): 25 x 60.5 mm					
		RAL 9016	Color	Matt Deluxe	Timber Effect & CH 703
	per m	57	68	80	80
Extension profile 50 mm Dimensions (W x D): 50 x 60.5 mm					
		RAL 9016	Color	Matt Deluxe	Timber Effect & CH 703
	per m	63	75	86	86

FrontGuard 65 Designs

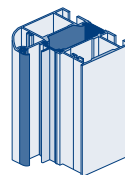
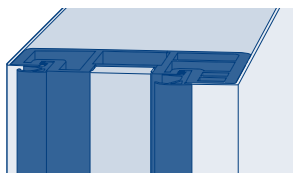

Profile A3

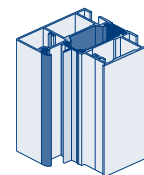

Profile A4

Size (W x H)	RAL 9016	Colour	Matt Deluxe	Timber Effect & CH 703
--------------	----------	--------	-------------	------------------------

Modern



FGS 600

- Insulated glass: Exterior has single-pane safety glass Satinato, edge with silkscreen clear-float/ single pane safety glass. Interior has single-pane safety glass Satinato, edged with Silkscreen, surface mounted exterior pane.

1000 x 2100				
1100 x 2100	2998	3123	3219	3247
from 700 x 1875				
up to 1250 x 2250	3384	3509	3606	3633
U <sub>D</sub> -value for size 1230 x 2180 mm: approx. 1.0 W/(m <sup>2</sup> ·K)				



FGS 700

- 3 panes of insulated glass: Exterior has laminated safety glass, sand-blasted float with 7 clear stripes. Interior has single-pane safety glass. - Stainless steel glazing frame.

1000 x 2100				
1100 x 2100	2677	2801	2898	2926
from 700 x 1875				
up to 1250 x 2250	3063	3187	3284	3312
U <sub>D</sub> -value for size 1230 x 2180 mm: approx. 0.98 W/(m <sup>2</sup> ·K)				



FGS 750

- 3 panes of insulated glass: Exterior has laminated safety glass, sand-blasted float with 5 clear stripes. Interior has single-pane safety glass. - Stainless steel glazing frame.

1000 x 2100				
1100 x 2100	2677	2801	2898	2926
from 875 x 1990				
up to 1250 x 2250	3063	3187	3284	3312
U <sub>D</sub> -value for size 1230 x 2180 mm: approx. 0.95 W/(m <sup>2</sup> ·K)				



FGS 800

- 3 panes of insulated glass: Exterior has laminated safety glass, Satinato. Interior has laminated safety glass. - Stainless steel glazing frame.

1000 x 2100				
1100 x 2100	2867	2992	3089	3116
from 875 x 1990				
up to 1250 x 2250	3252	3377	3474	3502
U <sub>D</sub> -value for size 1230 x 2180 mm: approx. 0.93 W/(m <sup>2</sup> ·K)				

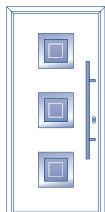

FGS 810

- 3 panes of insulated glass: Exterior has laminated safety glass, sand-blasted float with clear stripes (square). Interior has single-pane safety glass. - Stainless steel glazing frame.

1000 x 2100				
1100 x 2100	2867	2992	3089	3116
from 875 x 1990				
up to 1250 x 2250	3252	3377	3474	3502
U <sub>D</sub> -value for size 1230 x 2180 mm: approx. 0.97 W/(m <sup>2</sup> ·K)				



FGS 820

-3 panes of insulated glass: Exterior has laminated safety glass, Satinato. Interior has laminated safety glass. - Stainless steel glazing frame.

1000 x 2100				
1100 x 2100	2867	2992	3089	3116
from 875 x 1990				
up to 1250 x 2250	3252	3377	3474	3502
U <sub>D</sub> -value for size 1230 x 2180 mm: approx. 0.95 W/(m <sup>2</sup> ·K)				

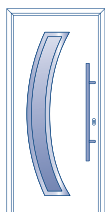

FGS 850

- 3 panes of insulated glass: Exterior has laminated safety glass, sand-blasted float with 7 clear stripes. Interior has laminated safety glass. - Stainless steel glazing frame.

1000 x 2100				
1100 x 2100	3091	3215	3312	3340
from 875 x 1990				
up to 1250 x 2250	3477	3601	3698	3726
U <sub>D</sub> -value for size 1230 x 2180 mm: approx. 0.97 W/(m <sup>2</sup> ·K)				

### FrontGuard 65 Designs

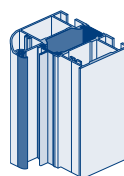
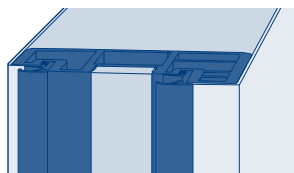

Profile A3

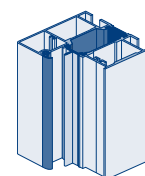

Profile A4

Size (W x H)	RAL 9016	Colour	Matt Deluxe	Timber Effect & CH 703
--------------	----------	--------	-------------	------------------------

### Modern

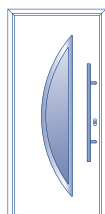

FGS 900

- 3 panes of insulated glass:  
Exterior has laminated safety glass, sand-blasted float with 4 clear stripes. Interior has laminated safety glass.
- Stainless steel glazing frame.

1000 x 2100 1100 x 2100	2867	2992	3089	3116
from 800 x 1875 up to 1250 x 2250	3252	3377	3474	3502

U<sub>D</sub>-value for size 1230 x 2180 mm: approx. 0.96 W/(m<sup>2</sup>·K)

### Classic



FGS 410

1000 x 2100 1100 x 2100	2860	3272	3369	-
from 875 x 1875 up to 1100 x 2186	3246	3658	3755	-

U<sub>D</sub>-value for size 1230 x 2180 mm: approx. 1.0 W/(m<sup>2</sup>·K)



FGS 430

1000 x 2100 1100 x 2100	2860	3272	3369	-
from 875 x 1990 up to 1100 x 2186	3246	3658	3755	-

U<sub>D</sub>-value for size 1230 x 2180 mm: approx. 1.0 W/(m<sup>2</sup>·K)

### Contemporary



FGS 010

1000 x 2100 1100 x 2100	1742	1867	1964	1992
from 700 x 1875 up to 1250 x 2250	2128	2252	2349	2377

U<sub>D</sub>-value for size 1230 x 2180 mm: approx. 0.87 W/(m<sup>2</sup>·K)

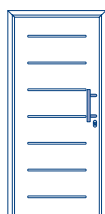

FGS 015

1000 x 2100 1100 x 2100	1830	1954	2051	2079
from 875 x 1875 up to 1250 x 2250	2216	2341	2438	2465

U<sub>D</sub>-value for size 1230 x 2180 mm: approx. 0.87 W/(m<sup>2</sup>·K)



FGS 515

1000 x 2100 1100 x 2100	1830	1954	2051	2079
from 700 x 1875 up to 1250 x 2250	2216	2341	2438	2465

U<sub>D</sub>-value for size 1230 x 2180 mm: approx. 0.87 W/(m<sup>2</sup>·K)



FrontGuard 65 Designs

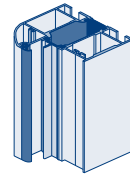
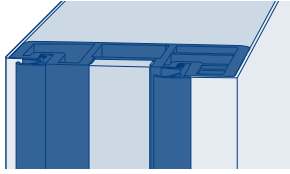

Profile A3

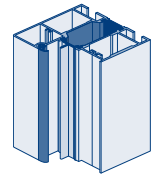

Profile A4

Size (W x H)	RAL 9016	Colour	Matt Deluxe	Timber Effect & CH 703
--------------	----------	--------	-------------	------------------------

Modern – Models with one-way plate glass

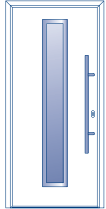

FGS 700N

- 3 panes of insulated glass:  
Exterior has laminated safety glass, one-way plate glass.  
Interior has single-pane safety glass.
- Stainless steel glazing frame.

1000 x 2100	2677	2801	2898	2926
1100 x 2100				
from 700 x 1875 up to 1250 x 2250	3063	3187	3284	3312

U<sub>D</sub>-value for size 1230 x 2180 mm: approx. 0.98 W/(m<sup>2</sup>·K)

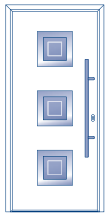

FGS 810N

- 3 panes of insulated glass:  
Exterior has laminated safety glass, one-way plate glass.  
Interior has single-pane safety glass.
- Stainless steel glazing frame.

1000 x 2100	2867	2992	3089	3116
1100 x 2100				
from 875 x 1990 up to 1250 x 2250	3252	3377	3474	3502

U<sub>D</sub>-value for size 1230 x 2180 mm: approx. 0.97 W/(m<sup>2</sup>·K)

## FrontGuard 65 Designs – Side elements and transom lights

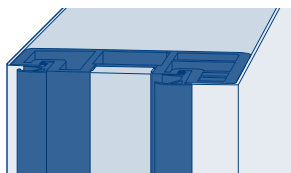

Ordering sizes Overall frame (W x H)	Glass	RAL 9016	Colour	Matt Deluxe	Timber Effect & CH 703
---	-------	----------	--------	-------------	------------------------

### Side Element

Fixed side element assembly

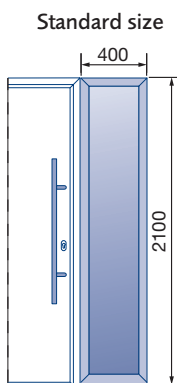

Standard size					
400 x 2100	Clear	1038	1170	1258	1213
	Satinato	1038	1170	1258	1213
	Sand-blasted	1038	1170	1258	1213
	Sand-blasted with clear stripes	1599	1731	1819	1774
	One-way plate glass	1188	1320	1408	1363

### Side Element

Fixed side element assembly

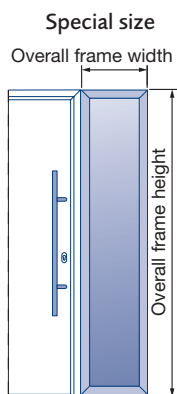

Special size					
From 300 x 700 Up to 500 x 2250	Clear, Satinato, cathedral glass or sand-blasted	1238	1370	1459	1414
Up to 1000 x 2250 <sup>1</sup>		1435	1567	1656	1610
From 300 x 700 Up to 500 x 2250	One-way plate glass	1388	1520	1609	1564
Up to 1000 x 2250 <sup>1</sup>		1567	1699	1788	1743
From 300 x 1875 Up to 500 x 2250	Sand-blasted with clear stripes	1946	2079	2167	2122
Up to 1000 x 2250 <sup>1</sup>		2142	2275	2363	2318

<sup>1</sup> Only possible without transom light  
Door set with side element does not contribute to the static equilibrium.  
Statics must be ensured by the building structure.

### Transom light

Fixed transom light assembly

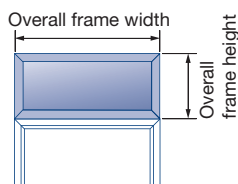



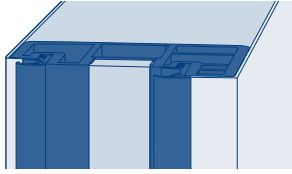

From 700 x 300 Up to 1250 x 500	Clear, Satinato, cathedral glass or sand-blasted	834	967	1054	1009
Up to 1750 x 500		1005	1138	1225	1180
Up to 2250 x 500		1236	1369	1458	1413
From 700 x 300 Up to 1250 x 500	One-way plate glass	984	1117	1204	1159
Up to 1750 x 500		1139	1272	1359	1314
Up to 2250 x 500		1350	1483	1570	1525

FrontGuard 65 Designs – Overview of panels / glass for side elements



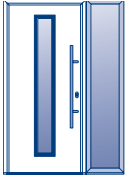
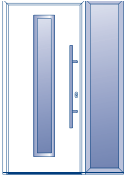
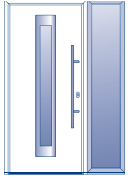
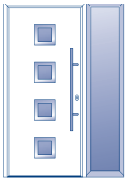
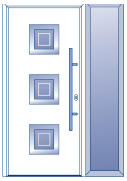

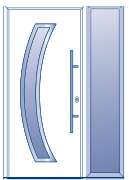
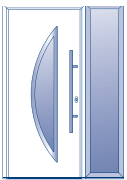
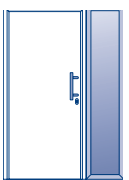
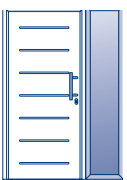
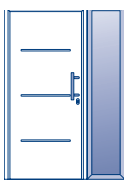
**Infill / size range**

Glass design: Exterior pane clear laminated safety glass – intermediate pane – interior pane clear laminated safety glass

	Style	Glass(interior pane)	Size range	
			Side element	Transom light
Modern	   FGS 600    FGS 700    FGS 750	1. Clear laminated safety glass / sand-blasted laminated safety glass (without clear stripes) 2. Clear laminated safety glass / clear laminated safety glass	Width 300 - 1000 mm  Height 1990 - 2250 mm	Width 875 - 2250 mm  Height 300 - 500 mm
	   FGS 800    FGS 810    FGS 820			
	  FGS 850    FGS 900			
Contemporary	   FGS 010    FGS 015    FGS 515	1. Clear laminated safety glass / Mastercarré single-pane safety glass 2. Clear laminated safety glass / single-pane safety ornamental glass 504 3. Clear laminated safety glass / sand-blasted laminated safety glass (without clear stripes) 4. Clear laminated safety glass / clear laminated safety glass	Width 300 - 1000 mm  Height 1875 - 2250 mm	Width 700 - 2250 mm  Height 300 - 500 mm
Classic	  FGS 410    FGS 430	1. Clear laminated safety glass/ sand blasted float without clear stripes/ clear laminated safety glass 2. Clear laminated safety glass/ float/ clear laminated safety glass	Width 300 - 1000 mm  Height 1875 - 2186 mm	Width 875 - 2000 mm  Height 300 - 500 mm

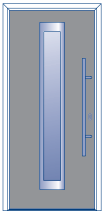

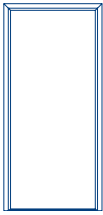
### FrontGuard 65 Designs – Door leaf and frame in different colours/surfaces

Colours of Leaf and frame differ			Door leaf	Frame	Price for entrance door with surface
			RAL 9016	Color	Color
			RAL 9016	Matt deluxe	Matt deluxe
			RAL 9016	Timber effect / CH 703	Timber effect / CH 703
			Color	RAL 9016	Color
			Color	Matt deluxe	Matt deluxe
			Color	Timber effect / CH 703	Timber effect / CH 703
			Matt deluxe	RAL 9016	Matt deluxe
			Matt deluxe	Color	Matt deluxe
			Matt deluxe	Timber effect / CH 703	Timber effect / CH 703
			Timber effect / CH 703	RAL 9016	Timber effect / CH 703
			Timber effect / CH 703	Matt deluxe	Timber effect / CH 703
			Timber effect / CH 703	Color	Timber effect / CH 703

### FrontGuard 65 Designs – Two-Colour entrance doors, side elements or transom light

Door leaf and frame / side element / transom light:  
 - Exterior finishes in decors Golden Oak, Dark Oak or Titan Metallic CH 703.  
 - Interior in Traffic white RAL 9016.  
 For frame profile A3.  
 Opening inwards.  
 Not possible for styles FGS 100, FGS 410 and FGS 430.

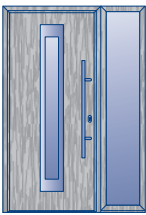
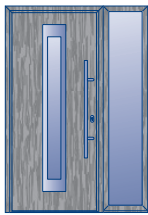
Surcharge for version with decor surface		
Per door	Per side element	Per transom light
129	61	61

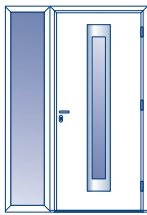
Exterior entrance door / side element			Interior
			
Golden Oak	Dark Oak	Titan Metallic CH 703	Traffic white RAL 9016

### FrontGuard 65 Designs – Bottom Spacer Profile

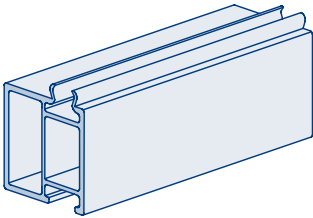
 <p>Bottom spacer profile</p>	Length up to 1250 mm	Height	30 mm	Each	28
		Height	60 mm	Each	55
		Height	90 mm	Each	83
		Height	120 mm	Each	110
		Height	150 mm	Each	136
	Length up to 2250 mm	Height	30 mm	Each	46
		Height	60 mm	Each	91
		Height	90 mm	Each	136
		Height	120 mm	Each	182
		Height	150 mm	Each	227
	Length up to 3250 mm	Height	30 mm	Each	65
		Height	60 mm	Each	130
		Height	90 mm	Each	194
		Height	120 mm	Each	259
		Height	150 mm	Each	324

### FrontGuard 65 Designs – Extension profile

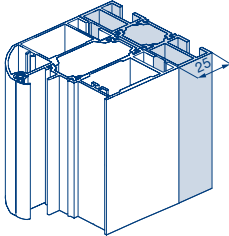
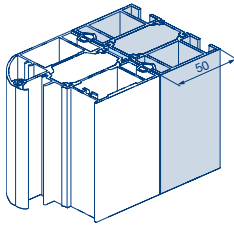
 <p>Extension profile 25 mm Dimensions (W x D): 25 x 80 mm</p>		RAL 9016	Color	Matt Deluxe	Timber Effect & CH 703
	per m	63	75	86	86
 <p>Extension profile 50 mm Dimensions (W x D): 50 x 80 mm</p>		RAL 9016	Color	Matt Deluxe	Timber Effect & CH 703
	per m	68	80	91	-

## FrontGuard Door Specifications

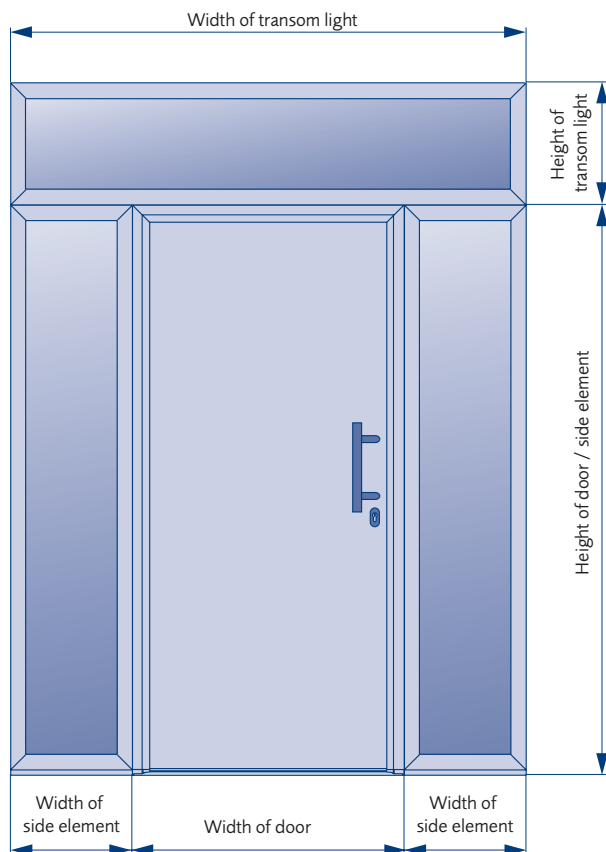

Side view of door

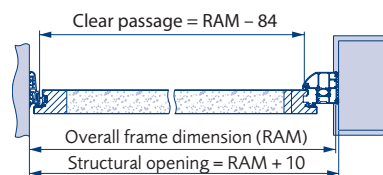

Plan view of door

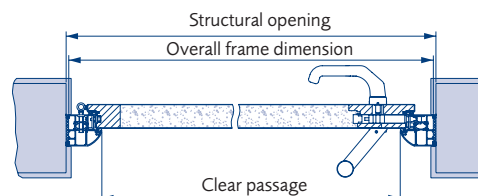

Plan view of door with side element

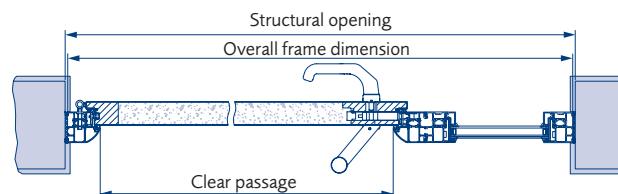

Roundstyle frame

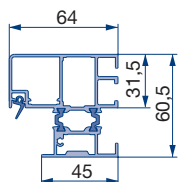

Quadrangular frame

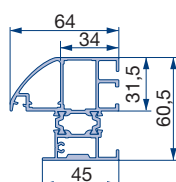

Plan view of door with side element

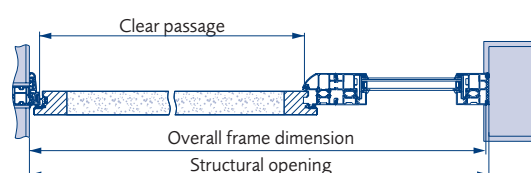

## Optional extras

Aluminium letter plate in gold or silver (only available on Classic Range)	54
Outside knob / inside lever in silver (only available on Classic Range)	137
Spyhole in chrome (for fitting on site, door leaf supplied undrilled). The hole for the spyhole needs to be drilled onsite and the kit needs to be fitted manually.	55
Profile cylinder complete (35.5 + 27.5 mm), supplied with 8 keys	53
Profile cylinder complete (35.5 + 27.5 mm), supplied with 10 keys	62
Electric strike with day catch (separate)	103
Large brushed stainless steel handle (surcharge for standard bar handle)	137
Stainless steel cleaner and care product (150 ml)	34
Option of door opening outwards	82